

INSTALLATION INSTRUCTIONS

DESCRIPTION: FR. Winch Mount Kit

PART NUMBER: BAR-F28M0-V0

MODEL: '20~ Wolverine X2/X4 R-Spec



⚠ WARNING

Please read and understand these instructions completely before installation to avoid possible injury, or damage to the accessory or vehicle.

NOTICE:

Installation of this kit requires a torque wrench and should be performed by an authorized Yamaha dealer or a qualified mechanic.

WARRANTY INFORMATION:

In the United States, see your Yamaha dealer for a copy of the Yamaha Genuine Parts and Accessories Limited Warranty.

DEALER OR INSTALLER:

These instructions contain important information for future reference and *must* be given to the customer.

Note: Only the VRX winch and only with the OE Brush Guard.

PARTS LIST:

No.	Part Number	Description	Qty
--	BAR-F28M0-V0	FR. WINCH MOUNT KIT	1
①	*	Plate	1

* Part supplied with kit only and not available separately.

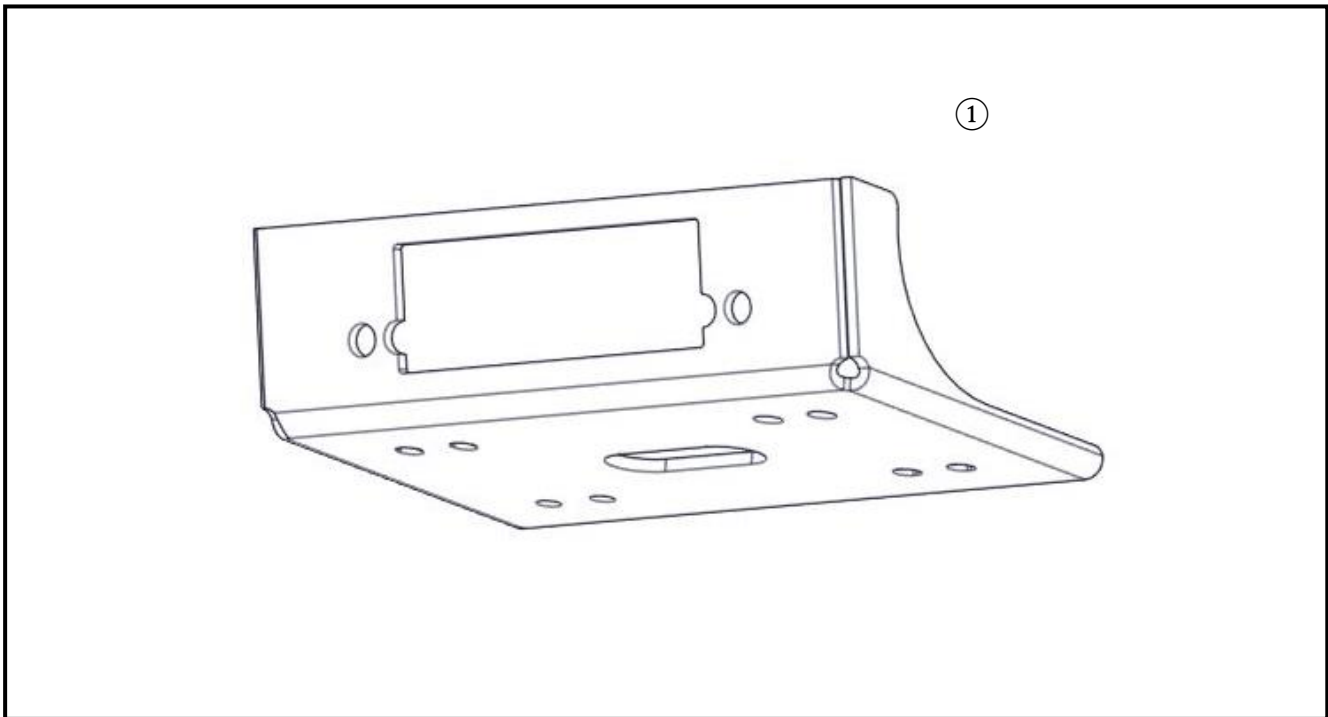

Fig. 1

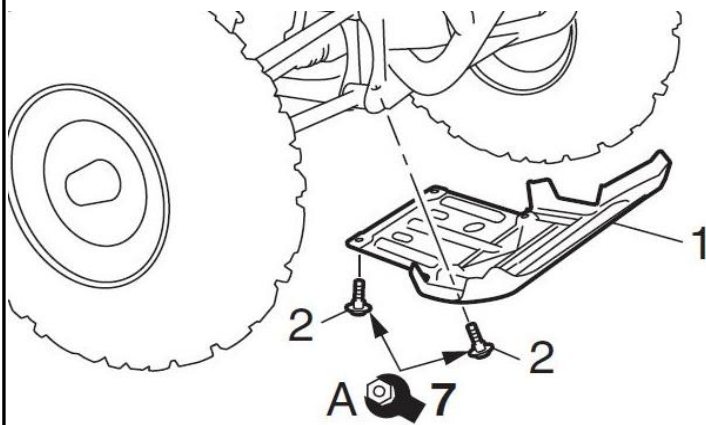

Fig. 2

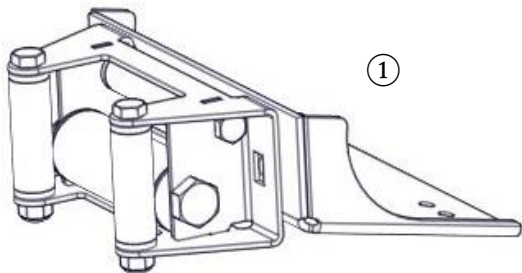
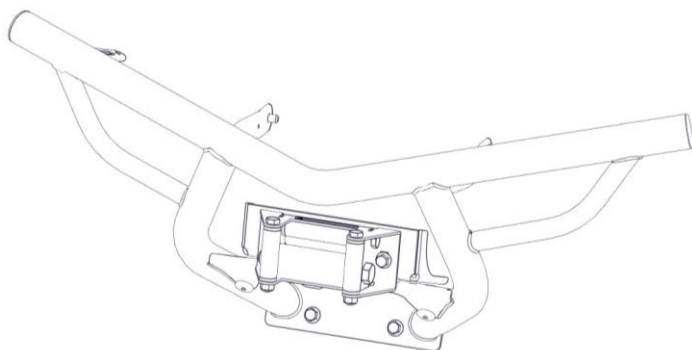

Fig. 3



PREPARATION:

- Place the vehicle on a secure and level surface. Set the parking brake.
- Clean the mount surfaces before beginning installation.

INSTALLATION:

1. Remove 4 bolts that secure the OE plastic front skid plate to the vehicle. Retain all parts for reuse. (Fig 1)
2. Unpack the winch kit and verify the kit is complete. Read the winch kit instructions.
3. Attach the fairlead to the ① winch mount. (Fig. 2) 16 Nm torque nuts (12 Ft-Lb or 1.6 m-kg)
4. Place the ① winch mount and fairlead in the OE Carry Front Bar. (Fig. 3)
5. Use the mounting hardware from the winch kit to attach the winch and winch mount to the Carry Front Bar. 16Nm (12 Ft-Lb or 1.6 m-kg)
6. Refer to the Warn instructions to connect the wires and controls for the winch.
7. Install the OE front skid plate to the mounting points using the OE bolts. Torque the bolts to 7 Nm (0.7 kg-m or 5.1 ft-lb). Refer to (Fig. 1).

MAINTENANCE:

Periodically, check torque on all hardware. If loose hardware is found, re-torque to specification.

CARE AND CLEANING:

Clean painted metal parts with a clean soft cloth and mild soap and water solution. Rinse and dry.

CUSTOMER SERVICE:

For further information see your Yamaha dealer.

ESTIMATED TIME TO INSTALL: 0.5 HRS.